

The MOST accurate way to ensure joints are being torqued correctly

The ATTB is a calibrated torque bar that is designed to take the place of a pipe joint in either an Iron Roughneck or a Make/Break machine. By placing this torque bar in the same position as a pipe joint, it is able to accurately measure the torque that a joint would see during make up.

The ATTB is able to accurately measure torque without being affected by bending caused by machine misalignment or wear.

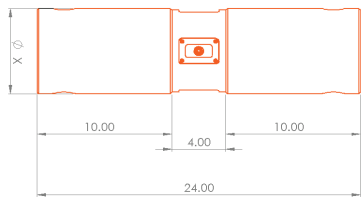

Ø X	(inches)	5 1/2	6 5/8	8 5/8
Torque	(ft.lbs.)	40,000	80,000	120,000
Ø X	(mm)	140	168	219
Torque	(Nm)	54,500	108,500	162,700

Specs:

Accuracy +/- 0.5 % of full scale

Temp Range -40° F - 150° F (-40° C - 65° C)

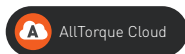

ALLTORQUE CONTROL SYSTEMS
 Bay 108, 239 Spruce Street
 Red Deer County, Alberta
 Canada T4E 1B4

Toll Free: 888-506-TORQ (8677)
Local: 403-309-2220
Fax: 403-346-1410
Email: info@alltorque.ca

www.alltorque.ca

AllTorque
 has the most reliable,
 field ready products to move
 the industry forward. Better Tools
 mean better results and more
 reliable field data